

宗地图

单位: m^2

宗地代码: 441302020004GB00997

所在图幅号: 2551.20-523.50

宗地面积: 30210

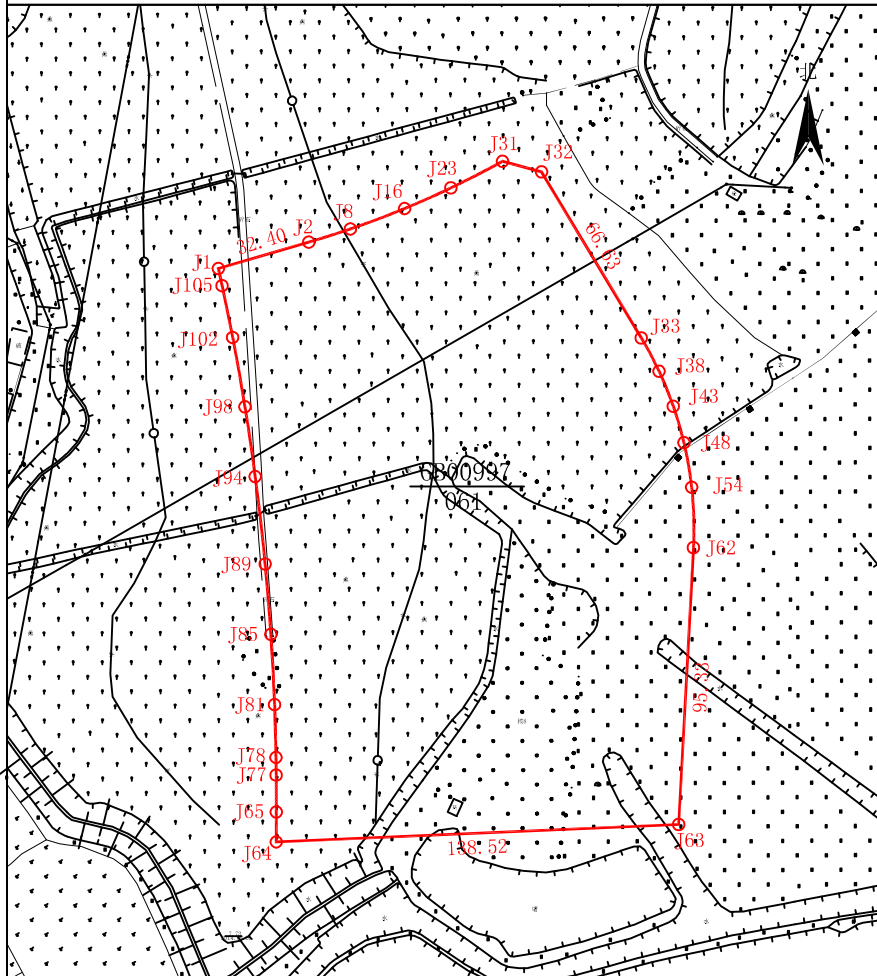

惠州仲恺高新区不动产登记局

2020年12月解析法测绘界址点

制图日期: 2020年12月07日

审核日期: 2020年12月07日

1:2600

绘图员: 雷朝

审核员: 赵细元



界址点坐标表

点号	X	Y	边长
J1	2551836.278	524156.616	32.40
J2	2551845.339	524187.721	2.49
J3	2551846.039	524190.112	2.49
J4	2551846.763	524192.498	2.49
J5	2551847.506	524194.879	2.49
J6	2551848.268	524197.253	2.49
J7	2551849.048	524199.622	2.49
J8	2551849.845	524201.984	2.49
J9	2551850.662	524204.340	2.49
J10	2551851.496	524206.690	2.49
J11	2551852.348	524209.033	2.49
J12	2551853.219	524211.370	2.49
J13	2551854.107	524213.700	2.49
J14	2551855.014	524216.023	2.49
J15	2551855.938	524218.339	2.49
J16	2551856.880	524220.648	2.49
J17	2551857.840	524222.949	2.49
J18	2551858.818	524225.243	2.49
J19	2551859.814	524227.529	2.49
J20	2551860.827	524229.807	

界址点坐标表

点号	X	Y	边长
J20	2551860.827	524229.807	2.49
J21	2551861.857	524232.078	2.49
J22	2551862.905	524234.341	2.49
J23	2551863.971	524236.595	2.49
J24	2551865.054	524238.841	2.49
J25	2551866.154	524241.079	2.49
J26	2551867.271	524243.308	2.49
J27	2551868.406	524245.528	2.49
J28	2551869.558	524247.740	2.49
J29	2551870.727	524249.943	2.49
J30	2551871.912	524252.136	2.49
J31	2551873.115	524254.321	13.90
J32	2551869.521	524267.751	66.63
J33	2551812.397	524302.050	2.60
J34	2551810.153	524303.367	2.60
J35	2551807.883	524304.656	2.60
J36	2551805.588	524305.860	2.60
J37	2551803.267	524307.055	2.60
J38	2551800.924	524308.164	2.60
J39	2551798.557	524309.243	

界址点坐标表

点号	X	Y	边长
J39	2551798.557	524309.243	2.60
J40	2551796.169	524310.275	2.60
J41	2551793.760	524311.257	2.60
J42	2551791.332	524312.189	2.60
J43	2551788.885	524313.072	2.60
J44	2551786.421	524313.904	2.60
J45	2551783.940	524314.685	2.60
J46	2551781.443	524315.416	2.60
J47	2551778.932	524316.095	2.60
J48	2551776.408	524316.723	2.60
J49	2551773.871	524317.299	2.60
J50	2551771.323	524317.823	2.60
J51	2551768.765	524318.295	2.60
J52	2551766.198	524318.714	2.60
J53	2551763.623	524319.080	2.60
J54	2551761.041	524319.394	2.60
J55	2551758.452	524319.655	2.60
J56	2551755.860	524319.862	2.60
J57	2551753.263	524320.017	2.60
J58	2551750.664	524320.118	

界址点坐标表

点号	X	Y	边长
J58	2551750.664	524320.118	2.60
J59	2551748.063	524320.166	2.60
J60	2551745.462	524320.161	2.60
J61	2551742.861	524320.102	2.60
J62	2551740.262	524319.990	95.33
J63	2551645.061	524314.918	138.52
J64	2551639.066	524176.528	10.29
J65	2551649.353	524176.529	1.05
J66	2551650.407	524176.534	1.06
J67	2551651.462	524176.538	1.06
J68	2551652.518	524176.540	1.06
J69	2551653.574	524176.541	1.06
J70	2551654.632	524176.541	1.06
J71	2551655.690	524176.540	1.06
J72	2551656.749	524176.537	1.06
J73	2551657.809	524176.533	1.06
J74	2551658.869	524176.528	1.06
J75	2551659.931	524176.522	1.06
J76	2551660.993	524176.514	1.06
J77	2551662.056	524176.505	

界址点坐标表

点号	X	Y	边长
J77	2551662.056	524176.505	6.06
J78	2551668.113	524176.428	6.06
J79	2551674.169	524176.308	6.06
J80	2551680.225	524176.143	6.06
J81	2551686.279	524175.955	6.06
J82	2551692.331	524175.684	6.06
J83	2551698.382	524175.388	6.06
J84	2551704.430	524175.049	6.06
J85	2551710.476	524174.667	6.06
J86	2551716.519	524174.241	6.06
J87	2551722.558	524173.771	6.06
J88	2551728.594	524173.258	6.06
J89	2551734.626	524172.701	6.06
J90	2551740.654	524172.101	6.06
J91	2551746.677	524171.457	6.06
J92	2551752.696	524170.770	6.06
J93	2551758.710	524170.040	6.06
J94	2551764.718	524169.266	6.06
J95	2551770.720	524168.449	6.06
J96	2551776.716	524167.588	

界址点坐标表

点号	X	Y	边长
J96	2551776.716	524167.588	6.06
J97	2551782.706	524166.685	6.06
J98	2551788.689	524165.738	6.06
J99	2551794.666	524164.748	6.06
J100	2551800.635	524163.715	6.06
J101	2551806.596	524162.639	6.06
J102	2551812.550	524161.520	6.06
J103	2551818.495	524160.358	6.06
J104	2551824.432	524159.154	6.06
J105	2551830.359	524157.906	6.06
J1	2551836.278	524156.616	

S=30210 平方米 合45.3150亩

2000国家大地坐标系, 中央子午线114度
仲恺高新区潼湾镇三和村ZKD-006-07号地块