

宗地图

单位: m.m²

宗地代码: 441302020004GB00996

所在图幅号: 2552.00-524.00

宗地面积: 40545

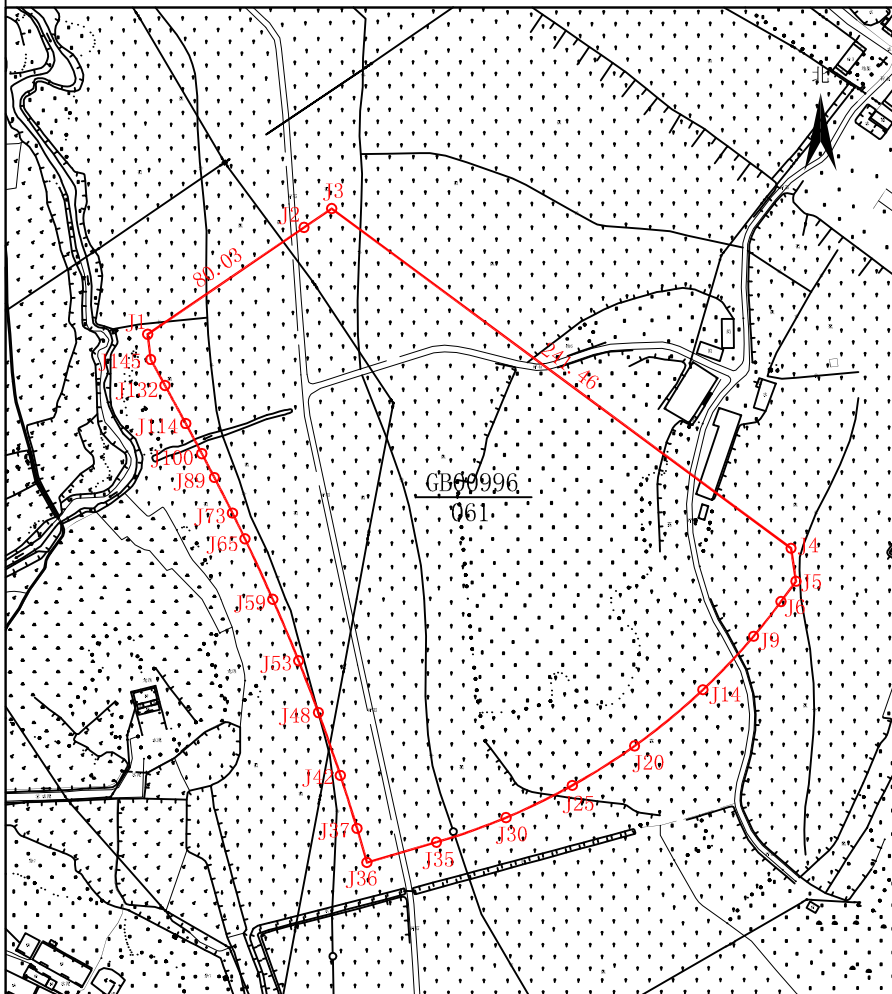

惠州仲恺高新区不动产登记局

2020年12月解析法测绘界址点

1:3300

绘图员: 雷朝

制图日期: 2020年12月07日

审核员: 赵细元

审核日期: 2020年12月07日



界址点坐标表

点号	X	Y	边长
J1	2552104.198	524052.793	
J2	2552149.343	524118.877	80.03
J3	2552197.321	524130.555	14.14
J4	2552013.747	524324.686	241.46
J5	2551999.777	524326.802	14.13
J6	2551991.214	524320.497	10.63
J7	2551986.235	524316.743	6.24
J8	2551981.342	524312.878	6.24
J9	2551976.336	524308.904	6.24
J10	2551971.822	524304.823	6.24
J11	2551967.201	524300.637	6.24
J12	2551962.675	524296.348	6.24
J13	2551958.247	524291.958	6.24
J14	2551953.918	524287.470	6.24
J15	2551949.692	524283.285	6.24
J16	2551945.570	524278.207	6.24
J17	2551941.555	524273.437	6.24
J18	2551937.488	524268.577	6.24
J19	2551933.851	524263.611	6.24
J20	2551930.166	524258.601	

界址点坐标表

点号	X	Y	边长
J20	2551930.166	524258.601	6.24
J21	2551926.596	524253.489	6.24
J22	2551925.141	524248.298	6.24
J23	2551919.805	524243.030	6.24
J24	2551916.588	524237.689	6.24
J25	2551913.491	524232.277	6.24
J26	2551910.518	524226.796	6.24
J27	2551907.668	524221.250	6.24
J28	2551904.944	524215.641	6.24
J29	2551902.347	524209.972	6.24
J30	2551899.879	524204.246	6.24
J31	2551897.539	524198.466	6.24
J32	2551895.331	524192.635	6.24
J33	2551893.254	524186.756	6.24
J34	2551891.210	524180.831	6.24
J35	2551889.500	524174.864	30.64
J36	2551886.935	524168.841	15.00
J37	2551895.338	524141.248	4.69
J38	2551899.829	524139.890	4.69
J39	2551904.312	524138.507	

界址点坐标表

点号	X	Y	边长
J39	2551904.312	524138.507	4.69
J40	2551908.787	524137.099	4.69
J41	2551913.235	524135.665	4.69
J42	2551917.714	524134.207	4.69
J43	2551922.166	524132.721	4.69
J44	2551926.660	524131.216	4.69
J45	2551931.043	524129.683	4.69
J46	2551935.469	524128.126	4.69
J47	2551939.886	524126.544	4.69
J48	2551944.294	524124.937	4.69
J49	2551948.693	524123.306	4.69
J50	2551953.083	524121.650	4.69
J51	2551957.463	524119.969	4.69
J52	2551961.834	524118.265	4.69
J53	2551966.198	524116.535	4.69
J54	2551970.549	524114.782	4.69
J55	2551974.890	524113.004	4.69
J56	2551979.222	524111.202	4.69
J57	2551983.544	524109.376	4.69
J58	2551987.855	524107.525	

界址点坐标表

点号	X	Y	边长
J58	2551987.855	524107.525	4.69
J59	2551992.156	524105.651	4.69
J60	2551996.447	524103.753	4.69
J61	2552000.727	524101.830	4.69
J62	2552004.996	524099.884	4.69
J63	2552009.254	524097.914	4.69
J64	2552013.501	524095.921	4.69
J65	2552017.737	524093.903	4.69
J66	2552021.962	524091.862	4.03
J67	2552022.389	524091.410	1.06
J68	2552023.843	524090.944	1.06
J69	2552024.796	524090.477	1.06
J70	2552025.747	524090.008	1.06
J71	2552026.698	524089.539	1.06
J72	2552027.647	524089.070	1.06
J73	2552028.595	524088.599	1.06
J74	2552029.541	524088.128	1.06
J75	2552030.487	524087.656	1.06
J76	2552031.431	524087.184	1.05
J77	2552032.374	524086.710	

界址点坐标表

点号	X	Y	边长
J77	2552032.374	524086.710	1.05
J78	2552033.315	524086.236	1.05
J79	2552034.256	524085.762	1.05
J80	2552035.195	524085.286	1.05
J81	2552036.133	524084.810	1.05
J82	2552037.070	524084.334	1.08
J83	2552038.028	524083.845	1.05
J84	2552038.962	524083.368	1.05
J85	2552039.899	524082.890	1.05
J86	2552040.826	524082.411	1.05
J87	2552041.757	524081.932	1.05
J88	2552042.686	524081.452	1.05
J89	2552043.615	524080.972	1.04
J90	2552044.542	524080.494	1.04
J91	2552045.468	524080.010	1.04
J92	2552046.393	524079.529	1.04
J93	2552047.317	524079.047	1.04
J94	2552048.239	524078.565	1.04
J95	2552049.161	524078.082	1.04
J96	2552050.081	524077.599	

界址点坐标表

点号	X	Y	边长
J96	2552050.081	524077.599	1.04
J97	2552051.001	524077.116	1.04
J98	2552051.919	524076.632	1.04
J99	2552052.836	524076.148	1.04
J100	2552053.753	524075.663	1.04
J101	2552054.668	524075.178	1.04
J102	2552055.582	524074.692	1.03
J103	2552056.495	524074.208	1.03
J104	2552057.407	524073.723	1.03
J105	2552058.318	524073.237	1.03
J106	2552059.228	524072.751	1.03
J107	2552060.137	524072.265	1.03
J108	2552061.045	524071.778	1.03
J109	2552061.952	524071.292	1.03
J110	2552062.858	524070.805	1.03
J111	2552063.763	524070.318	1.03
J112	2552064.667	524069.831	1.03
J113	2552065.570	524069.344	1.03
J114	2552066.473	524068.857	1.02
J115	2552067.374	524068.370	

界址点坐标表

点号	X	Y	边长
J115	2552067.374	524068.370	1.02
J116	2552068.274	524067.882	1.02
J117	2552069.174	524067.395	1.02
J118	2552070.072	524066.908	1.02
J119	2552070.970	524066.420	1.02
J120	2552071.866	524065.933	1.02
J121	2552072.762	524065.445	1.02
J122	2552073.657	524064.958	1.02
J123	2552074.551	524064.471	1.02
J124	2552075.444	524063.983	1.02
J125	2552076.336	524063.496	1.02
J126	2552077.228	524063.009	1.02
J127	2552078.118	524062.522	1.02
J128	2552079.008	524062.035	1.01
J129	2552079.897	524061.548	1.01
J130	2552080.785	524061.061	1.01
J131	2552081.672	524060.575	1.01
J132	2552082.559	524060.089	1.01
J133	2552083.444	524059.603	1.01
J134	2552084.329	524059.117	

界址点坐标表

点号	X	Y	边长
J134	2552084.329	524059.117	1.01
J135	2552085.211	524058.631	1.01
J136	2552086.096	524058.145	1.01
J137	2552086.979	524057.660	1.01
J138	2552087.861	524057.175	1.01
J139	2552088.742	524056.690	1.01
J140	2552089.622	524056.208	1.00
J141	2552090.501	524055.722	1.00
J142	2552091.380	524055.238	1.00
J143	2552092.258	524054.754	1.00
J144	2552093.136	524054.271	0.45
J145	2552093.529	524054.055	10.74
J1	2552104.198	524052.793	

S=40345 平方米 合60.8176亩
2000国家大地坐标系，中央子午线114度
梓潼高新区潼南镇三和村ZK0-006-05号地块